

---

# INSTALLATION AND OPERATION INSTRUCTIONS FOR BACK BAR REFRIGERATION

---

## INSPECTION

When the equipment is received, all items should be carefully checked against the Bill of Lading to ensure all crates and cartons have been received. Do not sign the freight bill clear until the freight has been properly inspected for damage. All units should be inspected for damage including concealed damage by uncrating immediately. If any damage is found, it should be reported to the carrier at once, noted on the Bill of Lading and a claim should be filed with the carrier. This equipment has been inspected and tested in the manufacturing facility and has been crated in accordance with transportation rules and guidelines. The manufacturer is not responsible for freight loss or damages.

## INSTALLATION

After removing the unit from the packaging, clean the interior and exterior surfaces of the unit with soap and water and a rinse with clean water. Do not use chlorinated cleaners on the surfaces as they can cause corrosion.

This unit is designed for indoor use only. Be sure to locate the unit where the floor can support the weight of the unit and product installed inside of it. The refrigeration system located at the bottom left of the unit requires free air access for proper operation. Allow a minimum of two inches between the back of the cabinet and the wall. Do not locate the unit next to heat generating equipment or in direct sunlight.

Confirm that the proposed electrical outlet has the correct voltage, frequency and current carrying capacity for the requirements of the unit. This information is noted on the data plate on the inside left wall of the unit. The unit should be isolated on a circuit. Do not use an extension cord to get power to the unit. Improper electrical installations will void the compressor warranty. To prevent shock and fire, be sure the unit is properly grounded.

Local health codes may require that the unit be sealed to the floor with an NSF approved silicone sealant if it is not on legs or casters. After the unit is set in its desired location, simply apply a bead of sealant around the base of the unit and smooth it out.

The shelves and shelf support clips are shipped inside the cabinet. Install the shelf support clips on the pilasters mounted on the inside walls of the cabinet and set the shelves on the supports. The shelves are adjustable in ½" increments to suit your needs.

## **OPERATION AND MAINTENANCE**

This cooler is designed to maintain your product temperature within the most desirable range of 34°F to 38°F. You can expect this temperature with the proper temperature control setting and in a normal environment. It is important to remember that when the product is delivered, it must be placed inside the cooler as soon as possible to avoid excessive warm up. If this happens, it may take many hours for the temperature to be reduced to the desirable range.

The temperature controller is located on the inside left wall of the unit. Turn the control clockwise for cooler temperatures and counterclockwise for warmer temperatures. Allow the unit several hours to respond to temperature control adjustments.

There are interior lights located above each door. The lights have on/off switches on each light.

When loading the cabinet with product, do not block the air flow path. Blocking the air flow may decrease performance. Maintain clearance between the contents and air duct on the inside left end for best performance.

This equipment is intended for the storage and display of non-potentially hazardous bottled or canned product only.

### **Cleaning**

Beginning with the initial installation, the interior surfaces of the cabinet should be periodically cleaned with a solution of warm water and baking soda. This solution will remove any odors from spillage that has occurred. The exterior of the cabinet should also be cleaned frequently with a commercial stainless steel cleaner, glass cleaner or mild soap solution. Do not use chlorinated cleaners on any surfaces.

The shelving can be cleaned in a sink with a mild soap solution and a soft bristled brush.

### **Condenser Coil**

Prior to cleaning the condenser coil disconnect the unit from power. Periodic cleaning of the condenser coil will aid the heat transfer of the refrigeration system and increase its efficiency. To accomplish this, remove the lower front grill from the cabinet. The condenser coil is located behind the grill. Use a soft bristled brush to remove any dirt particles that are on the fins of the condenser coil. Use a vacuum cleaner or compressed air to remove the loosened particles. Replace the front grill and reconnect the unit to power. Failure to clean the condenser coil can lead to performance loss and compressor failure.

# TROUBLESHOOTING

Problem	Remedy
Compressor will not start	<ul style="list-style-type: none"> <li>• Check the power cord and make sure it is plugged in and has power.</li> <li>• Check the temperature controller. If it is in the “OFF” position, turn it clockwise to set a desired temperature.</li> </ul>
Poor performance	<ul style="list-style-type: none"> <li>• Move the unit from direct sunlight.</li> <li>• Move the unit away from heating devices.</li> <li>• Install the unit in a well ventilated place, with at least 2 inches of clearance on all sides.</li> <li>• Clean the condenser if heavy dust is collected.</li> <li>• Clear contents from blocking the inside air duct.</li> <li>• Check the temperature controller for correct setting.</li> <li>• Check the doors and be sure they are completely closed.</li> </ul>
Unit noisy	<ul style="list-style-type: none"> <li>• Install the unit on a level solid surface.</li> <li>• Maintain 2 inches of clearance from the wall.</li> <li>• Check for loose parts or mounting.</li> <li>• Keep the tubing free from any contact to avoid rattle.</li> </ul>
Condensation on cabinet exterior and/or floor	<ul style="list-style-type: none"> <li>• Reduce humidity where the unit is installed.</li> <li>• Check the drain line to make sure it is not disconnected inside the cabinet and it drains into the drain pan in the compressor area.</li> </ul>

## SPECIFICATIONS\*

Model	# of Doors	# of Shelves	Electrical	Amps	NEMA Plug	HP	BTU Capacity	Refrigerant	Capacity 12oz. cans
BB59	2	4	115/60/1	6.6	5-15P	1/3	1666	R134a 10.6 oz.	640
BB59G	2	4	115/60/1	6.6	5-15P	1/3	1666	R134a 10.6 oz.	640
BB69	2	4	115/60/1	6.6	5-15P	1/3	1666	R134a 10.6 oz.	800
BB69G	2	4	115/60/1	6.6	5-15P	1/3	1666	R134a 10.6 oz.	800
BB79	3	6	115/60/1	6.6	5-15P	1/3	1666	R134a 10.6 oz.	920
BB79G	3	6	115/60/1	6.6	5-15P	1/3	1666	R134a 10.6 oz.	920
BB95	3	6	115/60/1	7.2	5-15P	1/3	1666	R134a 10.6 oz.	1160
BB95G	3	6	115/60/1	7.2	5-15P	1/3	1666	R134a 10.6 oz.	1160

## BB SERIES REPLACEMENT PARTS LISTS

Item No.	Standex PN	Description	Model				
			BB59	BB69	BB79	BB95	
1	150315	Compressor 115V	X	X	X	X	
2	150316	Compressor Start Kit 115V	X	X	X	X	
3	150206	Condenser Coil	X	X	X	X	
4	150207	Condenser Fan Motor 115V	X	X	X	X	
5	150232	Evaporator Coil	X	X	X	X	
6	150234	Evaporator Fan Motor 115V	X	X	X	X	
7	150236	Evaporator Fan Blade	X	X	X	X	
8	150238	Evaporator Fan Guard	X	X	X	X	
9	150211	Thermostat	X	X	X	X	
10	150212	Thermostat Knob	X	X	X	X	
11	150239	Light 3 Pin Connector	X	X	X	X	
12	150213	Power Cord 115V	X	X	X	X	
13	150241	Cap Tube	X	X	X	X	
14	150325	Heavy Duty Mobility Kit (not shown)	X	X			
	150326				X	X	
15	150243	Door Assy, Solid Black	X	X	X	X	
	150244	Door Assy, Solid Black (small)			X		
	150245	Door, Glass	X	X	X	X	
	150246	Door, Glass (small)			X		
16	150247	Door Gasket, Solid Door	X	X	X	X	
	150248	Door Gasket, Solid Door (small)			X		
	150249	Door Gasket, Glass Door	X	X	X	X	
	150250	Door Gasket, Glass Door (small)			X		
17	150251	Door Handle, Solid Door	X	X	X	X	
18	150253	Hinge Kit, Door (incl. Top/Bottom Hinges & Bush)	X	X	X	X	
19	150254	Door Lock Assy	X	X	X	X	
20	150255	Lock Key	X	X	X	X	
25	150262	Back Panel	X	X	X	X	
26	150263	Side Panel	X	X	X	X	
27	150264	Front Grill	X	X	X	X	
30	150268	Shelf, Right/Left/Center	X				
	150269			X			
	150270						X
		150268	Shelf, Right			X	
		150271	Shelf, Left			X	
		150272	Shelf, Center			X	
		150317	Shelf w/Guides, Right/Left	X		X	
		150318			X		
		150319	Shelf w/Guides, Right/Left				X
		150320	Shelf w/Guides, Center				X
		150321	Shelf w//Guides, Center			X	
		150322	Shelf w/Guides, Left			X	
31	150273	Pilaster	X	X	X	X	
32	150274	Shelf Support	X	X	X	X	
33	150280	Top Assembly				X	
	150281				X		
	150282			X			
	150283		X				
35	150227	Rear Bumper	X	X	X	X	
36	150328	Floor Protector Kit (not shown)	X				
	150329			X			
	150330				X		
	150331						X

\* Above specifications are subjected to change without prior notice for quality improvement.

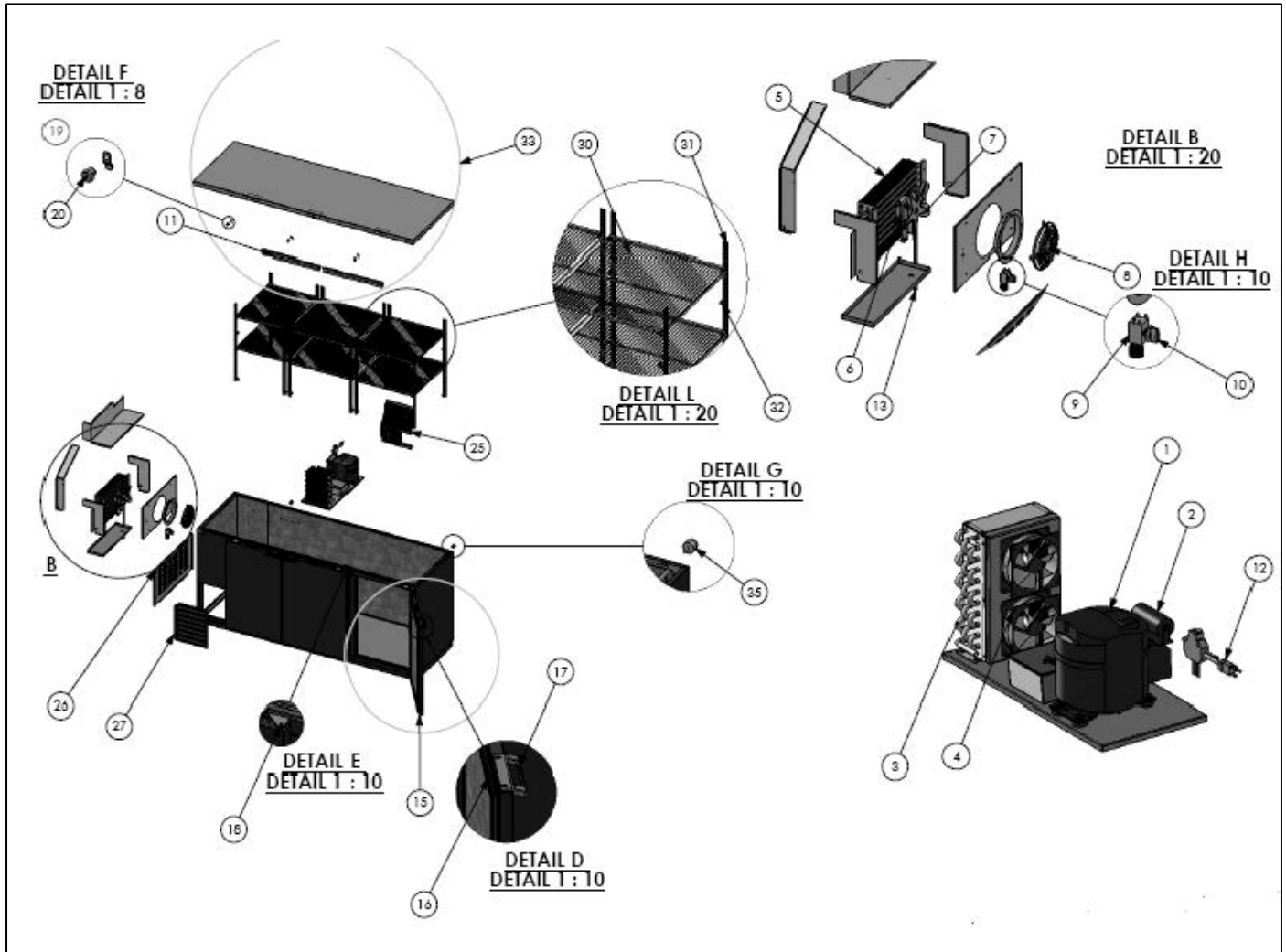

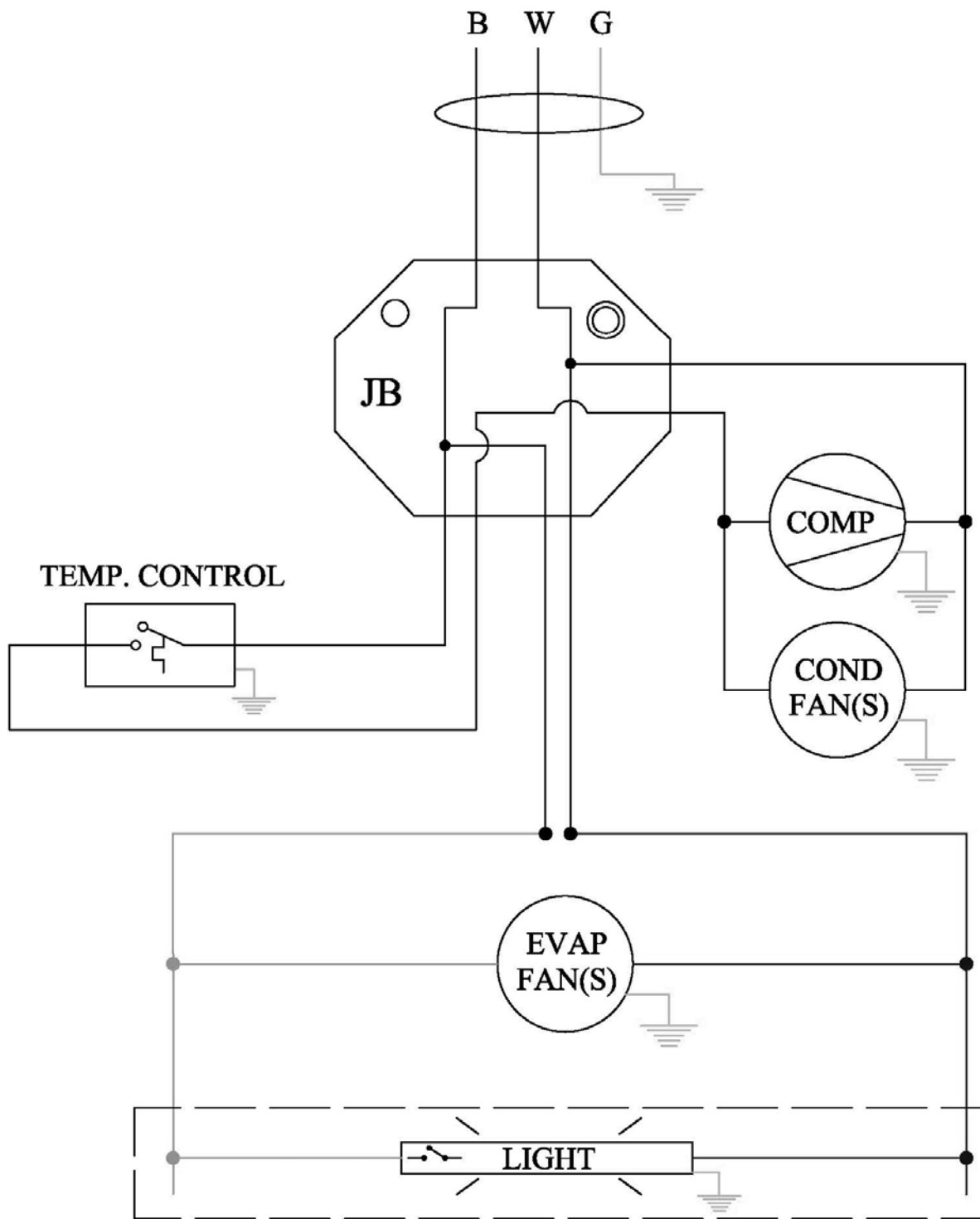

OPTIONAL LIGHT

Aplica a:	Back Bar / Beer Dispenser / Bottle Coolers	C.I.	0	Rev.	0
Dib. Num.:	DE-STANDEX-CM				