

Symphony™ countertop and wall mount ice and water dispensers with Maestro™ Chewblet® ice icemaker

25 Series

To select dispense method:

Add **-S** after model number for **SensorSAFE™** dispensing or **-L** for lever dispensing.

Countertop models with (A) air- or (W) water-cooled icemaker

- 25CT400A/W – 115V, 60Hz, integral icemaker
- 25CR400A/W – 115V, 60Hz, Satellite-fill icemaker
- C25CT400A/W – 220V, 60Hz, integral icemaker
- C25CR400A/W – 220V, 60Hz, Satellite-fill icemaker
- E25CT400A/W – 230V, 50Hz, integral icemaker
- E25CR400A/W – 230V, 50Hz, Satellite-fill icemaker

Wall mount models with (A) air- or (W) water-cooled icemaker

Note: Available with SensorSAFE dispensing only

- 25HT400A/W-S – 115V, 60Hz, integral icemaker
- 25HR400A/W-S – 115V, 60Hz, Satellite-fill icemaker
- C25HT400A/W-S – 220V, 60Hz, integral icemaker
- C25HR400A/W-S – 220V, 60Hz, Satellite-fill icemaker
- E25HT400A/W-S – 230V, 50Hz, integral icemaker
- E25HR400A/W-S – 230V, 50Hz, Satellite-fill icemaker



Symphony™

25CT400A-S (countertop with SensorSAFE™-S dispensing)

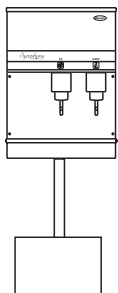

Countertop model with Satellite-fill icemaker

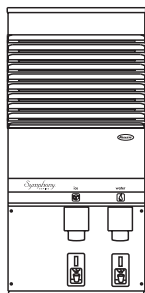

Wall mount model with integral icemaker* (SensorSAFE dispensing only)

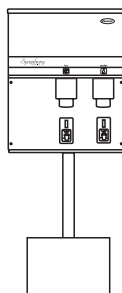

Wall mount model with Satellite-fill icemaker*

* No drain pan. Drain pan available – contact factory.

Countertop and wall mount ice and water dispensers with air- or water-cooled icemaker. Stainless steel frame and exterior with plastic trim. Up to 25 lbs (11kg) storage. Produces approximately 400 lbs (181kg) of Chewblet compressed nugget ice in a 24-hour period.

Add **-S** after model number for **SensorSAFE** dispensing or **-L** for lever dispensing.

Convenient, sanitary, user-friendly dispensing

- Labor-saving, sanitary automatic load
- Available with lever or infrared SensorSAFE dispensing
- Quick shut-off reduces the amount of wasted ice
- High-quality Chewblet compressed nugget ice is slow melting, easy to chew
- Clear chute focuses ice cleanly into cups, pitchers, carafes, ice bags

SensorSAFE dispensing option offers even more sanitation and convenience

- Infrared sensing eliminates container-to-dispenser contact; reduces chance of cross-contamination
- Easy, one-hand filling of containers

Space-saving, attractive design

- 21" (534mm) width requires less space than other models of similar capacity
- Zero side clearance required for ventilation
- Softly-rounded European styling
- High-quality stainless steel exterior with plastic trim

Environmentally friendly Maestro icemakers

- State-of-the-art R404A icemaker automatically loads dispenser with 400 lbs (181kg) of ice each day
- Stainless steel evaporator and auger
- Energy-efficient; no costly defrost cycles or high waste water
- Quiet production; no noisy harvest cycles
- Satellite-fill™ icemakers can be located up to 20 feet (6m) from dispenser; remove heat, noise and bulk from customer area

Accessories

- Chilled water option (item# AFH20CHIL2550)
- Water filter kit (item# 00130229)
- Base stand (for models 25CT400A/W, C/E25CT400A/W) (item# AF50BASESTD)
- SafeCLEAN™ environmentally friendly icemaker cleaner (item# 00132001)
- Slide-out track for Satellite-fill icemakers (item# AFGSLIDER400A (air-cooled icemakers) and item# AFGSLIDER400W (water-cooled icemakers))
- Drain pan assembly for wall mount models (item# AFH25WBASE)

JOB: _____

ITEM: _____

Maestro, SafeCLEAN, SensorSAFE and Symphony are trademarks of Follett Corporation. Chewblet is a registered trademark of Follett Corporation, registered in the US.

25 Series

Symphony™ countertop and wall mount ice and water dispensers with Maestro™ Chewblet® ice icemaker

Models with Satellite-fill icemaker (shown with lever dispensing (-L); infrared SensorSAFE dispensing (-S) available)

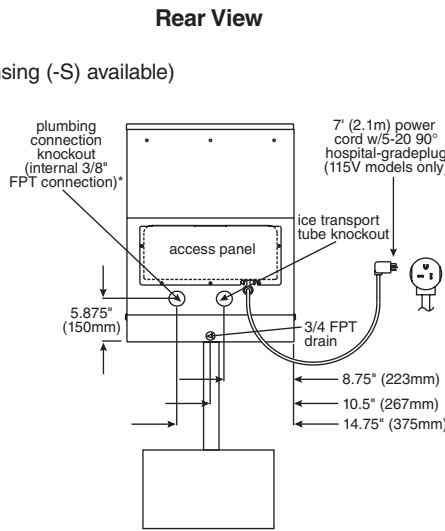
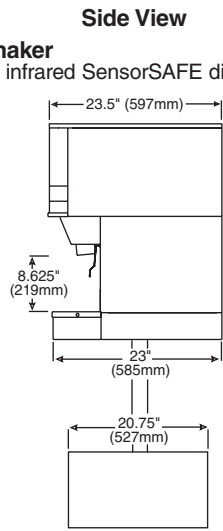
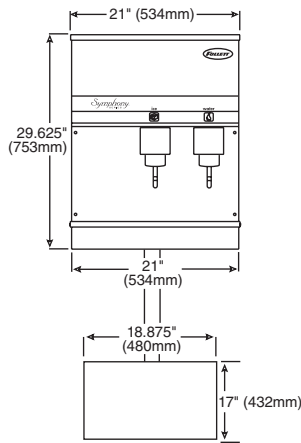

Models with integral icemaker (shown with lever dispensing (-L); infrared SensorSAFE dispensing (-S) available)

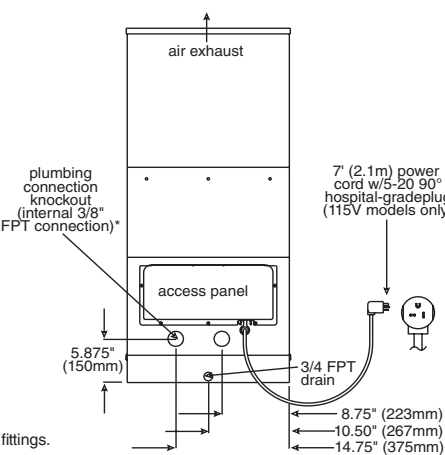
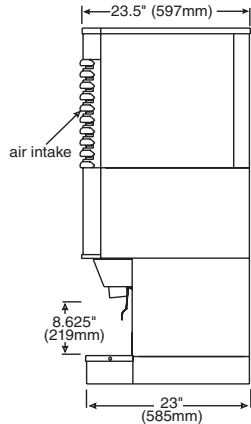
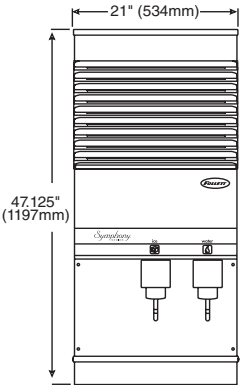

* Kit provided with all 230V, 50Hz and 220V, 60Hz models to connect to BSP water fittings.

Clearances

	Models with integral icemaker		Models with Satellite-fill icemaker	
	Air-cooled	Water-cooled	Air-cooled	Water-cooled
Required for ventilation	6" (153mm) top	N/A	6" (153mm) right side of icemaker	N/A
Recommended for service	12" (305mm) top	12" (305mm) top	12" (305mm) top of icemaker; 12" (305mm) top of dispenser	12" (305mm) top of icemaker; 12" (305mm) top of dispenser

See Dispenser Detail Sheet, form# 2075, for important installation information

Standard Electrical – 115V, 60Hz, 1 phase, 13 amps, max. fuse 20 amps. 7 ft (2.1m) cord and NEMA 5-20 hospital-grade plug provided with each dispenser. If local code requires hard-wiring, separate disconnects also required.

Alternate Electrical – 220V, 60Hz, 1 phase, 6.5 amps. 230V, 50Hz, 1 phase, 6.5 amps. Cord only. Wire in accordance with all local codes.

Approximate Shipping Weight 310 lbs (141kg)

Specifications Ice and water dispenser to be Follett automatic load in (choose one) ___ countertop or ___ wall mount configuration, with 25 lbs (11kg) of storage. Environmentally friendly R404A icemaker to be (choose one) ___ air- or ___ water-cooled and to be removable for cleaning and maintenance. Dispenser frame and cabinet to be stainless steel with plastic trim. Icemaker to produce approximately 400 lbs (181kg) of Chewblet compressed nugget ice at air temp. of 70 F (21 C), water temp. of 50 F (10 C). Icemaker to be equipped with printed circuit board and diagnostics to allow simplified servicing. Dispensers with Satellite-fill icemakers to be equipped with 10' (3m) of insulated ice transport tube, 2" (51mm) air duct for icemaker (air-cooled only) and lightweight plastic top that allows full access to the ice storage area for easy cleaning and manual loading of back-up ice. Storage area to be insulated with non-CFC, high density, foamed-in-place polyurethane. 7 ft (2.1m) cord and NEMA 5-20 hospital-grade plug provided (220V/230V models, cord only). Dispenser to be NSF, UL and cUL listed. 230V models also CE compliant.

Connections

- Countertop models: utilities connect through back or bottom. Back entry shown.
- Wall mount models: utilities connect through back
- Supplied 2" (51mm) duct and louver must be installed for undercounter Satellite-fill icemaker installations

Wall Mount Models

- Deduct 3.625" (92mm) from height and add .5" (13mm) to depth shown
- Wall mount bracket and SensorSAFE standard
- Standard without drain pan.
- Drain pan available – contact factory

Ice Production

Air-cooled icemaker capacity/24 hrs.

		Ambient Air Temperature °F/C						
		F 60	70	80	90	100		
Inlet Water Temperature °F/C	C	16	21	27	32	38		
	50	510	454	397	335	273	lbs.	
	10	232	206	180	152	124	kg.	
	60	482	435	389	329	270	lbs.	
	16	219	198	177	150	123	kg.	
	70	454	417	380	323	266	lbs.	
	21	206	190	173	147	121	kg.	
	80	424	385	347	297	247	lbs.	
	27	193	175	158	135	112	kg.	
	90	394	354	313	270	227	lbs.	
	32	179	161	142	123	103	kg.	

Water-cooled icemaker capacity/24 hrs.

		Ambient Air Temperature °F/C						
		F 60	70	80	90	100		
Inlet Water Temperature °F/C	C	16	21	27	32	38		
	50	451	447	442	437	428	lbs.	
	10	204	202	200	199	194	kg.	
	60	423	413	409	399	394	lbs.	
	16	192	187	185	181	179	kg.	
	70	394	390	380	371	361	lbs.	
	21	179	177	172	168	163	kg.	
	80	371	361	352	342	333	lbs.	
	27	168	163	160	155	151	kg.	
	90	352	342	333	323	309	lbs.	
	32	160	155	151	146	140	kg.	

Energy Consumption

KWH per 100 lbs (46kg) ice†	
Air-cooled	5.7
Water-cooled	5.5

† Air temp. 90 F (32 C); water temp. 70 F (21 C)

Heat Rejection Data

Model	Heat rejected in BTU/hr	
	to air	to water
Air-cooled	5000	N/A
Water-cooled	1400	3600

Water consumption

12.6 gal (48L) of potable water usage per 100 lbs (46kg) of ice.

Follett reserves the right to change specifications at any time without obligation. Certifications may vary depending on country of origin.